



WILLFIT: Core

WF-C-115: WillFit Core System



Using **UV Stable High-Density Polyethylene (HDPE)** in a WillFit Core System offers superior durability and longevity. It withstands sun damage, ensuring consistent performance in diverse weather conditions. Furthermore, its high strength-to-density ratio enhances structural integrity, while its environmentally friendly nature aligns with sustainable practices.

Features



Incorporating **Powder Coated Stainless Steel** in a WillFit Core System provides excellent durability and corrosion resistance. This high-quality material ensures a longer lifespan for the system. Its aesthetic finish offers an additional layer of protection while enhancing the system's visual appeal.

Activities

- Intergrated Sit Up
- 1100L Rail x3
- Multi Push Up
- 900 Roman Rings

WF-C-116: WillFit Core System



Using **UV Stable High-Density Polyethylene (HDPE)** in a WillFit Core System offers superior durability and longevity. It withstands sun damage, ensuring consistent performance in diverse weather conditions. Furthermore, its high strength-to-density ratio enhances structural integrity, while its environmentally friendly nature aligns with sustainable practices.

Features



Incorporating **Powder Coated Stainless Steel** in a WillFit Core System provides excellent durability and corrosion resistance. This high-quality material ensures a longer lifespan for the system. Its aesthetic finish offers an additional layer of protection while enhancing the system's visual appeal.

Activities

- Flag Pole
- Wall Squat Board
- 900 Roman Rings
- Multi Push Up
- Jump Box Near Post
- Sit Up & Leg Raise

WF-C-117: WillFit Core System



Utilising **Powder Coated Marine Grade Aluminium** in a WillFit Core System offers outstanding durability and corrosion resistance, especially in our harsh environment. Its lightweight strength aligns with superior system performance, while its sleek finish enhances aesthetic appeal. It significantly contributes to the system's longevity and reliability.

Features



Incorporating **Powder Coated Stainless Steel** in a WillFit Core System provides excellent durability and corrosion resistance. This high-quality material ensures a longer lifespan for the system. Its aesthetic finish offers an additional layer of protection while enhancing the system's visual appeal.

Activities

- 1400L Bent Rail x3

WF-C-118: WillFit Core System

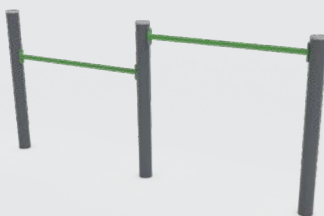

Utilising **Powder Coated Marine Grade Aluminium** in a WillFit Core System offers outstanding durability and corrosion resistance, especially in our harsh environment. Its lightweight strength aligns with superior system performance, while its sleek finish enhances aesthetic appeal. It significantly contributes to the system's longevity and reliability.

Features



Incorporating **Powder Coated Stainless Steel** in a WillFit Core System provides excellent durability and corrosion resistance. This high-quality material ensures a longer lifespan for the system. Its aesthetic finish offers an additional layer of protection while enhancing the system's visual appeal.

Activities

- 1400L Rail x2

WF-C-119: WillFit Core System

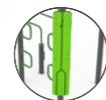

Using **UV Stable High-Density Polyethylene (HDPE)** in a WillFit Core System offers superior durability and longevity. It withstands sun damage, ensuring consistent performance in diverse weather conditions. Furthermore, its high strength-to-density ratio enhances structural integrity, while its environmentally friendly nature aligns with sustainable practices.

Features



Incorporating **Powder Coated Stainless Steel** in a WillFit Core System provides excellent durability and corrosion resistance. This high-quality material ensures a longer lifespan for the system. Its aesthetic finish offers an additional layer of protection while enhancing the system's visual appeal.

Activities

- Flag Pole
- 400 Entry Step
- 1100 Wide Overhead Ladder
- 1100L Rail
- Wall Squat Board
- Multi Push Up
- 1400L Rail
- Jump Box Near Post
- Parallel Bars to Post x2

All of WillPlay's Fitness Equipment is meticulously designed and constructed to meet the "Permanently Installed Outdoor Fitness Equipment" Standard, ensuring full compliance with **AS 16630:2021** for complete safety and quality assurance.

WILLFIT: CORE - Range Options

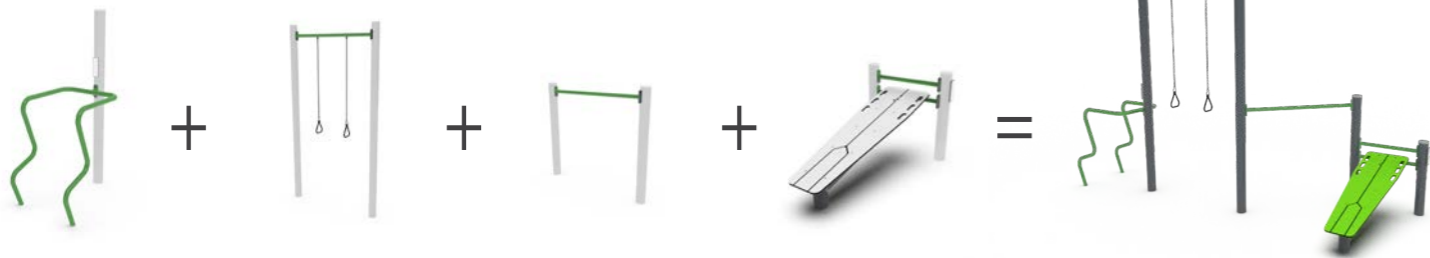

Every WillFit Core System is a unique composition of diverse activities. Each system is meticulously arranged and combined in numerous ways, affording a multitude of distinctive exercise systems. This adaptability caters to a wide range of preferences, ensuring an engaging and facilitated exercise experience for all.

WF-C-101: WillFit Core System



Using **UV Stable High-Density Polyethylene (HDPE)** in a WillFit Core System offers superior durability and longevity. It withstands sun damage, ensuring consistent performance in diverse weather conditions. Furthermore, its high strength-to-density ratio enhances structural integrity, while its environmentally friendly nature aligns with sustainable practices.

Features



Incorporating **Powder Coated Stainless Steel** in a WillFit Core System provides excellent durability and corrosion resistance. This high-quality material ensures a longer lifespan for the system. Its aesthetic finish offers an additional layer of protection while enhancing the system's visual appeal.

Activities

- Ball Target
- 1100L Rail
- Flag Pole
- Strap Hook
- 400 Entry Step
- 1200 Roman Rings
- Sit Up & Leg Raise
- Ladder
- Multi Push Up
- Staggered Overhead Ladder

WF-C-102: WillFit Core System



Using **UV Stable High-Density Polyethylene (HDPE)** in a WillFit Core System offers superior durability and longevity. It withstands sun damage, ensuring consistent performance in diverse weather conditions. Furthermore, its high strength-to-density ratio enhances structural integrity, while its environmentally friendly nature aligns with sustainable practices.

Features



Incorporating **Powder Coated Stainless Steel** in a WillFit Core System provides excellent durability and corrosion resistance. This high-quality material ensures a longer lifespan for the system. Its aesthetic finish offers an additional layer of protection while enhancing the system's visual appeal.

Activities

- Ball Target
- 1400L Rail
- 400 Entry Step
- 1200 Roman Rings
- Sit Up & Leg Raise
- Ladder
- Multi Push Up
- Staggered Overhead Ladder

WF-C-103: WillFit Core System



Using **UV Stable High-Density Polyethylene (HDPE)** in a WillFit Core System offers superior durability and longevity. It withstands sun damage, ensuring consistent performance in diverse weather conditions. Furthermore, its high strength-to-density ratio enhances structural integrity, while its environmentally friendly nature aligns with sustainable practices.

Features



Incorporating **Powder Coated Stainless Steel** in a WillFit Core System provides excellent durability and corrosion resistance. This high-quality material ensures a longer lifespan for the system. Its aesthetic finish offers an additional layer of protection while enhancing the system's visual appeal.

Activities

- Flag Pole
- Staggered Overhead Ladder
- 400 Entry Step
- 1200 Roman Rings
- Multi Push Up
- Wall Squat Board
- Parallel Bars to Post
- Sit Up & Leg Raise
- Jump Box Near Post
- 1100L Rail

WF-C-104: WillFit Core System



Utilising **Powder Coated Marine Grade Aluminium** in a WillFit Core System offers outstanding durability and corrosion resistance, especially in our harsh environment. Its lightweight strength aligns with superior system performance, while its sleek finish enhances aesthetic appeal. It significantly contributes to the system's longevity and reliability.

Features



Incorporating **Powder Coated Stainless Steel** in a WillFit Core System provides excellent durability and corrosion resistance. This high-quality material ensures a longer lifespan for the system. Its aesthetic finish offers an additional layer of protection while enhancing the system's visual appeal.

Activities

- Parallel Bars to Post
- Intergrated Sit Up
- Angled Rail 2350
- Ladder
- Net Climber
- 400 Entry Step
- Multi Push Up
- 1400L Rail x2

WF-C-107: WillFit Core System



Utilising **Powder Coated Marine Grade Aluminium** in a WillFit Core System offers outstanding durability and corrosion resistance, especially in our harsh environment. Its lightweight strength aligns with superior system performance, while its sleek finish enhances aesthetic appeal. It significantly contributes to the system's longevity and reliability.

Features



Incorporating **Powder Coated Stainless Steel** in a WillFit Core System provides excellent durability and corrosion resistance. This high-quality material ensures a longer lifespan for the system. Its aesthetic finish offers an additional layer of protection while enhancing the system's visual appeal.

Activities

- 1100L Rail x2

WF-C-108: WillFit Core System



Utilising **Powder Coated Marine Grade Aluminium** in a WillFit Core System offers outstanding durability and corrosion resistance, especially in our harsh environment. Its lightweight strength aligns with superior system performance, while its sleek finish enhances aesthetic appeal. It significantly contributes to the system's longevity and reliability.

Features



Incorporating **Powder Coated Stainless Steel** in a WillFit Core System provides excellent durability and corrosion resistance. This high-quality material ensures a longer lifespan for the system. Its aesthetic finish offers an additional layer of protection while enhancing the system's visual appeal.

Activities

- Ladder
- 1400L Rail
- Dip - Push Up

WF-C-109: WillFit Core System



In a WillFit Core System, the **Roto Moulded Plastic** Steps offer durability, safety, and ease of maintenance. Designed to withstand frequent usage, these steps feature an anti-slip surface for enhanced grip and safety.

Features



Incorporating **Powder Coated Stainless Steel** in a WillFit Core System provides excellent durability and corrosion resistance. This high-quality material ensures a longer lifespan for the system. Its aesthetic finish offers an additional layer of protection while enhancing the system's visual appeal.

Activities

- Staggered Overhead Ladder
- 400 Entry Step x2
- Multi Push Up
- Net Climber
- Ladder
- Angled Rail 2350
- Commando Net
- Overhead Tornado

WF-C-110: WillFit Core System

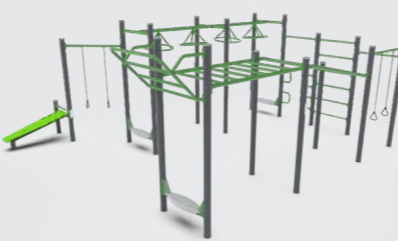

Using **UV Stable High-Density Polyethylene (HDPE)** in a WillFit Core System offers superior durability and longevity. It withstands sun damage, ensuring consistent performance in diverse weather conditions. Furthermore, its high strength-to-density ratio enhances structural integrity, while its environmentally friendly nature aligns with sustainable practices.

Features



Incorporating **Powder Coated Stainless Steel** in a WillFit Core System provides excellent durability and corrosion resistance. This high-quality material ensures a longer lifespan for the system. Its aesthetic finish offers an additional layer of protection while enhancing the system's visual appeal.

Activities

- Sit Up & Leg Raise
- 1100 Wide Overhead Incline Ladder
- 900 Roman Rings
- Multi Push Up
- Double Overhead Tornado
- 1100L Rail
- 1200 Roman Rings
- Incline Climb Rails
- 400 Entry Step x3
- Ladder
- Overhead Ladder Incline

WF-C-111: WillFit Core System



Using **UV Stable High-Density Polyethylene (HDPE)** in a WillFit Core System offers superior durability and longevity. It withstands sun damage, ensuring consistent performance in diverse weather conditions. Furthermore, its high strength-to-density ratio enhances structural integrity, while its environmentally friendly nature aligns with sustainable practices.

Features



Incorporating **Powder Coated Stainless Steel** in a WillFit Core System provides excellent durability and corrosion resistance. This high-quality material ensures a longer lifespan for the system. Its aesthetic finish offers an additional layer of protection while enhancing the system's visual appeal.

Activities

- Flag Pole
- 1100L Rail x5
- Wall Squat Board
- 900 Roman Rings
- 1200 Roman Rings
- Multi Dip Bench

WF-C-112: WillFit Core System



Using **UV Stable High-Density Polyethylene (HDPE)** in a WillFit Core System offers superior durability and longevity. It withstands sun damage, ensuring consistent performance in diverse weather conditions. Furthermore, its high strength-to-density ratio enhances structural integrity, while its environmentally friendly nature aligns with sustainable practices.

Features



Incorporating **Powder Coated Stainless Steel** in a WillFit Core System provides excellent durability and corrosion resistance. This high-quality material ensures a longer lifespan for the system. Its aesthetic finish offers an additional layer of protection while enhancing the system's visual appeal.

Activities

- Sit Up & Leg Raise Incline
- 1200 Roman Rings
- Dip - Push Up
- 1400L Rail

WF-C-113: WillFit Core System



Using **UV Stable High-Density Polyethylene (HDPE)** in a WillFit Core System offers superior durability and longevity. It withstands sun damage, ensuring consistent performance in diverse weather conditions. Furthermore, its high strength-to-density ratio enhances structural integrity, while its environmentally friendly nature aligns with sustainable practices.

Features



Using **16mm Woven Nylon Gal Core Rope with Aluminum & Nylon Rope Fittings** in a WillFit Core System ensures superior resilience and safety. This high-strength, lightweight material withstands heavy use. Its superior abrasion resistance prolongs the lifespan of the set. Paired with robust fittings, it ensures secure, reliable connections.

Activities

- Parallel Bars to Post
- Sit Up & Leg Raise
- Ladder
- Net Climber
- 900 Roman Rings
- Ball Target
- 1100L Rail
- 1400L Rail x2

WF-C-114: WillFit Core System

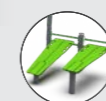
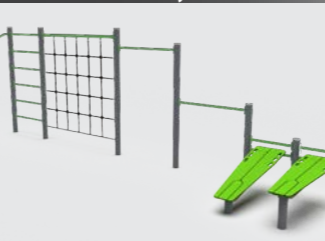

Using **UV Stable High-Density Polyethylene (HDPE)** in a WillFit Core System offers superior durability and longevity. It withstands sun damage, ensuring consistent performance in diverse weather conditions. Furthermore, its high strength-to-density ratio enhances structural integrity, while its environmentally friendly nature aligns with sustainable practices.

Features

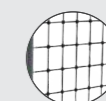

Using **16mm Woven Nylon Gal Core Rope with Aluminum & Nylon Rope Fittings** in a WillFit Core System ensures superior resilience and safety. This high-strength, lightweight material withstands heavy use. Its superior abrasion resistance prolongs the lifespan of the set. Paired with robust fittings, it ensures secure, reliable connections.

Activities

- Dip - Push Up
- Angled Rail 2350
- Ladder
- Commando Net
- 1400L Rail x2
- Sit Up & Leg Raise Incline
- Sit Up & Leg Raise

